

REFERENCE DATA
The data described and illustrated in this document, except those items which are vendor parts, has been developed by, and is the property of, Icore International Inc. Distribution, use, reproduction or manufacture of its contents, or any part, feature, design, function, or process shall not be made unless written consent therefor is granted by Icore International Inc.

DISCLAIMER STATEMENT
All dimensions represented on this drawing should be confirmed prior to inclusion within designs or specifications. Icore International Inc. is constantly incorporating product improvements, and therefore reserves the right to make changes without notice.

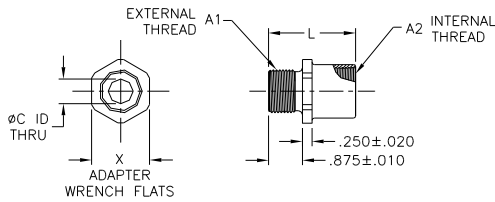

CONFIGURATION CODE 0
FIGURE 1

PART NUMBER DESCRIPTION

AX0928-####-@@

- SPECIAL ADAPTER
- CONFIGURATION CODE (ONLY THE CONFIGURATION SHOWN IS AVAILABLE FOR THIS PRODUCT SERIES AT THIS TIME, REFER TO FIGURE 1)
- STUFFING TUBE BUSHING MATES W/ AX#685 ADAPTERS & W/ MIL-S-24235/18 (SH) STUFFING TUBES
- STUFFING TUBE SIZE CODE (REFER TO TABLE 1)
- MATERIAL & FINISH (SEE BELOW)
 - SP MATERIAL: 316L STAINLESS STEEL FINISH: PASSIVATE PER ENTRACO PROCEDURE 1027 WITH MAT FINISH
 - CT MATERIAL: 6061-T6 SERIES ALUMINUM FINISH: ENTRACO TTH PLATING
- ADAPTER FITTING SIZE CODE (FEMALE THREAD) (REFER TO TABLE 1)

ENTRACO Sea-FROST™ System
STUFFING TUBE BUSHING
(MATES WITH MIL-S-24235/18 & AX0685)

ENTRACO Icore International Inc. 3780 Flightline Drive Santa Rosa, CA 95403-8227
CODE IDENT: SALES 05593 S DRAWING NUMBER: AX0928-TAB

REFERENCE DATA
The data described and illustrated in this document, except those items which are vendor parts, has been developed by, and is the property of, Icore International Inc. Distribution, use, reproduction or manufacture of its contents, or any part, feature, design, function, or process shall not be made unless written consent therefor is granted by Icore International Inc.

DISCLAIMER STATEMENT
All dimensions represented on this drawing should be confirmed prior to inclusion within designs or specifications. Icore International Inc. is constantly incorporating product improvements, and therefore reserves the right to make changes without notice.

STUFFING TUBE BUSHING ADAPTER

SIZE CODE	* TUBE SIZE DESIGNATOR		A1	A2	ØC	L	X
	TO MATE TO STUFFING TUBE	TO MATE TO AX0685 ADAPTER	R.H. EXTERNAL CLASS 2A THREAD	R.H. INTERNAL CLASS 2B THREAD			
2832	A	B	.875-12 UNF	1.000-12 UNF	±.010	±.020	±.015
3640	C	D	1.125-12 UNF	1.250-12 UNF	.640	2.250	1.500

TABLE 1
* PER MIL-S-24235/18

STUFFING TUBE BUSHING
(MATES WITH MIL-S-24235/18 & AX0685)

ENTRACO Icore International Inc. 3780 Flightline Drive Santa Rosa, CA 95403-8227
CODE IDENT: SALES 05593 S DRAWING NUMBER: AX0928-TAB